

¼ NPT CASE DRAIN PORT

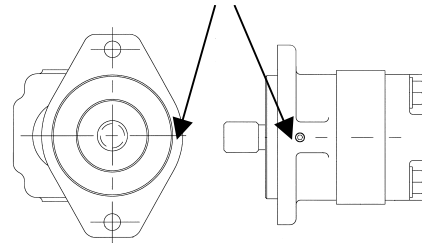

PART #	A	B	C	D	WHERE USED
719849	7 ½"	9 9/16" / 9 7/16"	5 ½"	¾"	9800 / 9801
719749	5 ¾"	7 1/8"	4"	½"	8700B,C / 9700
719649	7 ½"	9"	4"	½"	9700C

MODEL	MOTOR	SEAL KIT	TYPE	SHAFT TYPE
4700	714716	714754	GEAR	KEY
8700C	708777	708786	GEAR	SPLINE
9700C	719717	719229	GEAR	SPLINE
9800	719817	719229	GEAR	SPLINE
9801	719837	719229	GEAR	SPLINE

REFER TO SIL: HP97-01 FOR MORE INFORMATION

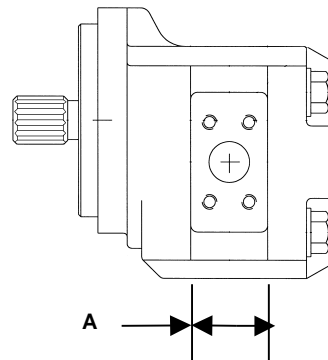

MODEL	4700	8700C	9700C	9800	9801
REQUIRED FLOW	7	17-20	28-30	42	55
RELIEF PRESSURE	2400	2400	2400	2400	2400
BACK PRESSURE	200*	100*	100*	100*	100*
CYCLES PER MINUTE	2000	2000	2000	2100	2100
DIMENSION "A"	-----	1-3/4 inch	2 inch	2-1/2 inch	3 inch
PORT DIMENSION - P	8 NPT	12 SORB	16 FLG 61	20 FLG 61	20 FLG 61
PORT DIMENSION - T	12 NPT	12 SORB	16 FLG 61	20 FLG 61	20 FLG 61
SHAFT ROTATION	CCW	bi-directional	bi-directional	bi-directional	bi-directional

* If return pressure (back pressure) exceeds value psi it may be necessary to connect case drain port directly to tank

ID Plate located on top mounting frame

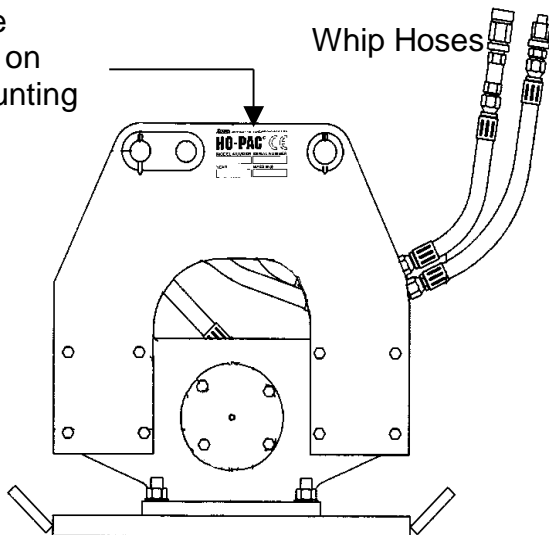

Second location of Serial Number is found on top edge of eccentric housing

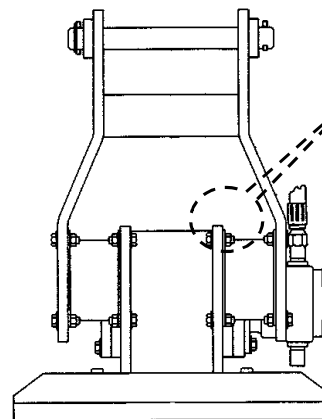

Motor