

Hydraulic Impact Breaker

**Model
AR130
&
AR130B**



Parts Manual AR-Series

Keep this manual in a convenient location so that it is easily accessible for future reference. Contact your Allied Dealer or the Allied Customer Service Department for replacement manuals. Inquiries regarding the content of this manual must include the effective date shown on inside cover.

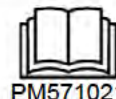

PM571021



Contact Information

Allied Construction Products, LLC
3900 Kelley Ave
Cleveland, Ohio 44114

E-mail: sales@alliedcp.com
Tel: 216-431-2600
Fax: 216-431-2601

Revision History of Document 571021 (and 101633 AR130)

Allied Construction Products, LLC, reserves the right to change, edit, delete or modify the content of this document, including descriptions, illustrations and specifications without prior notification. Specifications are based on published information at the time of publication. Go to www.alliedcp.com for product or document updates.

<u>Effective Date</u>	<u>Page</u>	<u>Summary of Changes For Document 571021</u>
Apr 15, 2005	All	1 st release of Document 571021
Jun 30, 2005	6, 10	P/N 571054, 571055, 571056 added
Aug 15, 2005	4,10,12	Discontinue PN 670269,PN 902766 replaced 101583,PN 571060 replaced 570776
Sep 12, 2005	20	Revise Table 4.9
Feb 06, 2006	8 & 6	Revise P/N 571893 & 570111
Sep 08, 2006	5,6,11-14	Revise housing plugs, lower bushing & o-ring
Aug 09, 2007		Revise Tune-Up Kit
Aug 28, 2007	5 & 6	Revise housing assembly
Oct 04, 2007	4 & 8	Revise flange port part numbers
Feb 27, 2008	4	Revise hydraulic adapter configuration
Apr 28, 2008	11, 12, 13, 14	PN 102346 - Revise description from Guide Seal to Guide Ring. PN 102410 – Revise description from seal to Seal w/ Anti-extrusion Ring
Jun 9, 2008	8	Revise flange adapter 572705 "IN" & 573221 "OUT"
Sep 10, 2008	14	Add illustration & table of parts for Tune-Up Kit
Nov, 2011	Throughout	Combine AR130 & AR130B into single parts manual. Add AR130 info to document 571021. Inactivate Document 101633. Discontinue use of guide ring 102346. Qty of o-ring 101783 was 8 (now 4) pcs.
Nov 22, 2011	25	Revise Fig 8-2 add note refer to O&M Manual for bolt hole dimensions
Sep 2012_B	6,10,14	Revise Table 3.1 Label Set. Table 4.2, items 9.1 & 9.2 correction made to part numbers. Add newer design air vent plug item 68.2. Revise seal set Fig.6-2.

<u>Effective Date</u>	<u>Page</u>	<u>Summary of Changes For 101633 (AR130)</u>
	All	1 st release of Document 101633
Jan 15, 2003	Cover, 22,23	Artwork added to cover, Tools added
May 30, 2003	Throughout	Corrections, drawings and parts list
Jul 15, 2003	5,11,12,13	Corrections to seal kit
Jun 30, 2005	5,15	P/N 571054, 571055, 571056 Added
Jul 13, 2005	5,8,11,12	Corrections to: Cylinder Head Table, Cylinder Drawing, Tool Holder Table, & Seal kit Drawing
Feb 6, 2006	5	Revise P/N 571893
May 29, 2008	Throughout	Corrections to Tune-Up Kit. Identify guide ring w/ grooves and seal w/ anti-extrusion ring. Update chisel paste information. N2 gas charge tool was 101441.
Sep 10, 2008	14	Add illustration & table of parts for Tune-Up Kit
Nov, 2011	---	Archive Document 101633. Superseded by 571021.

Table of Contents

<u>Section</u>	<u>Page</u>
Document Revisions.....	i
Table of Contents.....	ii
1.0 Introduction & Scope.....	1
1.1 Purpose of This Manual.....	1
1.2 About This Manual.....	1
1.3 How to Order Replacement Manuals..	1
1.4 Related Publications.....	1
2.0 Equipment Identification.....	3
2.1 Serial Number Location.....	3
2.2 Equipment Identification Tag.....	3
2.3 Owner's Record of the Equipment.....	3
3.0 Safety and Information Labels.....	4
3.1 Label Description and Location.....	4
4.0 Parts Information.....	7
4.1 Housing Box & Components.....	7
4.2 Breaker Assembly.....	9
4.3 Hydraulic Connections.....	17
5.0 Tool Selection.....	18
5.1 Standard Tools.....	18
5.2 Specialty Tools.....	18
5.3 Chisel Paste Bushing & Tool Lubricant	19
6.0 Service Kits & Tools.....	20
6.1 Tune-up Kit.....	20
6.2 Seal Set.....	21
6.3 N2 Gas Charge Tool.....	24
7.0 Mounting Brackets & Hardware....	25
8.1 Mounting Brackets.....	25
8.2 Connection Plate.....	25

<u>Section</u>	<u>Page</u>
How To Order Spare Parts.....	26

<u>List of Figures</u>	<u>Page</u>
2-1 Serial Number Location.....	3
2-2 Equipment Identification Tag.....	3
3-1 thru 3-14 Identification of Safety and Information Labels.....	3
3-15 Label Placement On the Equipment...	6
4-1 Housing & Box Components.....	7
4-2 Breaker Assembly.....	9
4-3 Hose Connections & Routing - Typical..	17
4-4 Hydraulic Connections.....	17
5-1 Tool Selection - Standard & Specialty	18
5-2 Tool Diameter & Working Length.....	18
6-1 Tune-up Kit.....	20
6-2 Seal Set – Valve Housing Seals.....	21
6-3 Position of Seals – Detail A.....	23
6-4 Position of Seals– Detail B.....	23
6-5 Position of Seals– Detail C, D.....	23
6-6 Position of Seals– Detail E.....	23
6-7 Accumulator N2 Gas Charge Tool.....	24
7-1 Housing Box & Mounting Bracket – Typ	25
7-2 Mounting Connection Plate.....	25

1.0 Introduction and Scope

1.1 Purpose of This Manual

The Parts Manual identifies each component of the Allied work tool including safety and information labels. Illustrations shown in the Parts Manual are not intended for use in the repair or service of the breaker.

1.2 About This Manual

This manual is an integral part of this product. Keep it in a convenient location so that it is easily accessible for future reference.

Table 1.1 About This Manual

Document ID No.	PM571021
Category	Spare Parts
Current Status	See Inside Cover
Product Name:	Hydraulic Impact Breaker
Series	AR
Applicable Model[s]:	AR130, AR130B
Years of Manufacture:	AR130 2005 & Before AR130B 2005 & After

Verify that the content in Table 1.1 corresponds with the information located on the Equipment's Identification Tag. Material presented in this Manual, including part name, part number, figures, descriptions and remarks, may not be suitable for models that are not listed in Table 1.1.

The content of this publication has been reviewed for accuracy. Allied Construction Products, LLC has endeavored to deliver the highest degree of accuracy possible. However, continuous improvement of our products is an Allied policy. The material in this publication, including descriptions, illustrations and specifications, describes the product at the time of its publication, and may not reflect the product in the future. Changes made to the content of this publication are recorded on the inside cover.

1.3 How To Order Replacement Manuals

Replacement manuals can be ordered by contacting your Allied dealer service center. These manuals may also be viewed and downloaded at: www.alliedcp.com

1.4 Related Publications

This document is published solely for information purposes and should not be considered all-inclusive. If further information is required, contact your local Allied dealer or the Allied Customer Service Department.

Allied Construction Products, LLC offers the following publications for the product identified in Table 1.1.

Safety, Operation & Maintenance Manual 102706

For use with AR-Series Breakers: AR110B – AR180C.

The Safety, Operation and Maintenance Manual has been prepared to assist the operator and maintenance personnel with the information necessary for the safe and proper use of the Allied work tool.

Content in the Safety, Operation & Maintenance Manual includes:

Safety Information
Equipment Serial Number and Model Identification
Technical Data (Weight & dimensions)
Basic Guidelines for Installation and Set-up
Pre-Operation Inspection
How to Operate the Allied work tool
Maintenance Schedule
N2 Gas Charging Instructions
Tool and Guide Bushing – Lubrication, Inspection, Wear Limits and Replacement
Troubleshooting
Removal From Carrier, Transporting, Lifting & Storage

Repair Manual 572591

Applicable Models: Medium & Large AR-Series

The Repair Manual has been prepared to assist the Service Technician with the information necessary for the disassembly & reassembly of the Breaker. Content includes:

Safety Information
Disassembly & Reassembly
Bolt Torque Specifications
Wear Limits of Parts
N2 Gas Charging Instructions
Bushing Replacement

1.0 Introduction and Scope – [cont'd]

1.4 Related Publications – cont'd

AEM Safety Manual for Hydraulic Breakers

The Association of Equipment Manufacturers offers a safety manual designed for operators and maintenance personnel of hydraulic mounted breakers. The manual is available in Spanish, French and English. It is published in an illustrated format of sensible do's and don'ts, featuring typical daily situations on the job site. Content includes safety tips concerning the workplace and equipment, start up and shut down guidelines and special operating and maintenance precautions.

This publication is available by contacting:

Association of Equipment Manufacturers

Toll free 1-866-AEM-0442

E-mail: aem@aem.org

Website: www.aem.org

Ask for FORM CMHB-1004, Hydraulic Mounted Breakers.

This publication is also available through Allied under part number 953076 (English). To order a copy, contact the Allied Customer Service Department.

2.0 Equipment Identification

2.1 Serial Number Location

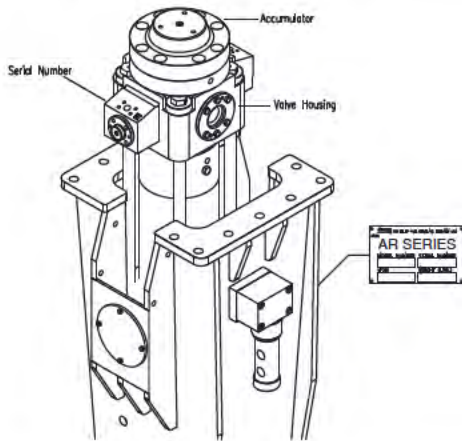

Fig 2-1 Equipment Identification

Refer to Figure 2-1. The Serial Number assigned to this equipment can be found in the following locations:

1. Stamped on the Equipment Identification Tag
2. Stamped on the valve housing [IN] port side.

2.2 Equipment Identification Tag

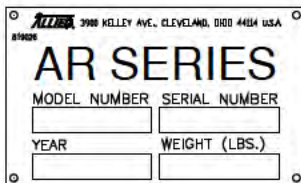

Fig 2-2 Equipment Identification Tag

The Equipment Identification Tag is affixed to the housing. It provides the following information:

- Manufacturer's name
- Address
- Product name
- Model number
- Serial number
- Year of manufacture
- Weight

Confirm that the information contained on the Tag corresponds with the information provided in Section 1, Table 1.1.

2.3 Owner's Record of the Equipment

- Record the Model and Serial Number from the Equipment Identification Tag to the space provided below.
- Indicate the date in which the Allied equipment was placed into service.

Model & Part
Number: _____

Serial Number: _____

In service date: _____

- Your local Allied dealer requires this information to better assist you with questions regarding parts, warranty, operation, maintenance, or repair.

Register this equipment by returning the completed warranty registration form to Allied.





3.0 Safety and Information Labels [cont'd]

3.1 Label Description and Location



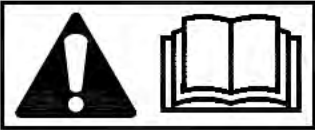

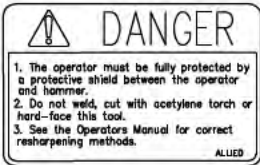

Information labels affixed to the Allied equipment include safety warnings, identification and instructions important to operation and service. Table 3.1 identifies and describes each label.

Keep all safety labels clean. Words and illustrations must be readable. Replace damaged or missing labels before operating this equipment. Refer to Table 3.2 for ordering information. Refer to Figure 3-14 for the label's location on the equipment.

Table 3.1 Identification Of Safety and Information Labels

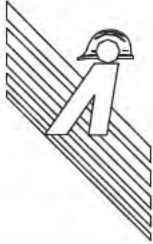
Figure	Label	Description
3-1		Read The Manual - Safety Alert Symbol with pictogram of open book. Gives notice of the importance of reading the manual(s) for information and/or instructions.
3-2		Keep Clear - Safety Alert Symbol with pictogram of breaker and person separated by arrow. Gives notice to personnel in vicinity of the breaker to maintain a safe distance. The operator must cease operation of the breaker if personnel enter the work zone.
3-3		Flying Debris Hazard – Alerts personnel to the hazard of fragments becoming projectiles. A protective guard to shield the operator must be installed before operation of the breaker. Personnel are directed to the Operator's Manual for safety instructions. NOTE: A smaller sized version of this decal is to be displayed in a conspicuous location inside the operator's cab.
3-4		Personal Protection Equipment / Tool Re-sharpening – Alerts personnel to provide protective shielding between the operator and breaker. It also warns against welding, cutting, or hard-facing the tool. Personnel are directed to the Operator's Manual for approved re-sharpening methods.
3-5		Pressurized Nitrogen Accumulator – Alerts personnel to the accumulator, warning of nitrogen gas under pressure. Directs personnel to the Operation and Maintenance Manual for service instructions.
3-6		Maximum Pressure – Alerts personnel the maximum operating pressure.

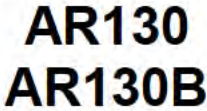
3.0 Safety and Information Labels [cont'd]

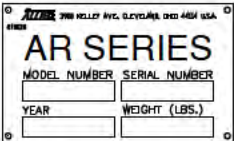
Figure	Label	Description
3-7		Lift Point – Pictogram of hook identifies approved lift points.
3-8		Tool Lubrication – Informs of lubrication frequency and the required position of the breaker before tool is lubricated.
3-9		Tool Lubrication Point – Identifies lubrication points.
3-10		Allied "A" with Stripes
3-11		ALLIED Logo - Decal is the Allied brand identifier and is a registered trademark of Allied Construction Products, LLC.
3-12		Model – Decal identifies the specific model of the equipment.
3-13		PRESSURE I.D. Tag – A red colored cable tie marked "PRESSURE LINE" is attached to the supply hose for ease of identification between hoses.
3-14		Equipment ID Tag - Contains identifying information about the equipment, including: Manufacturer's name, address, product name, model number, serial number, year of manufacture, and weight.

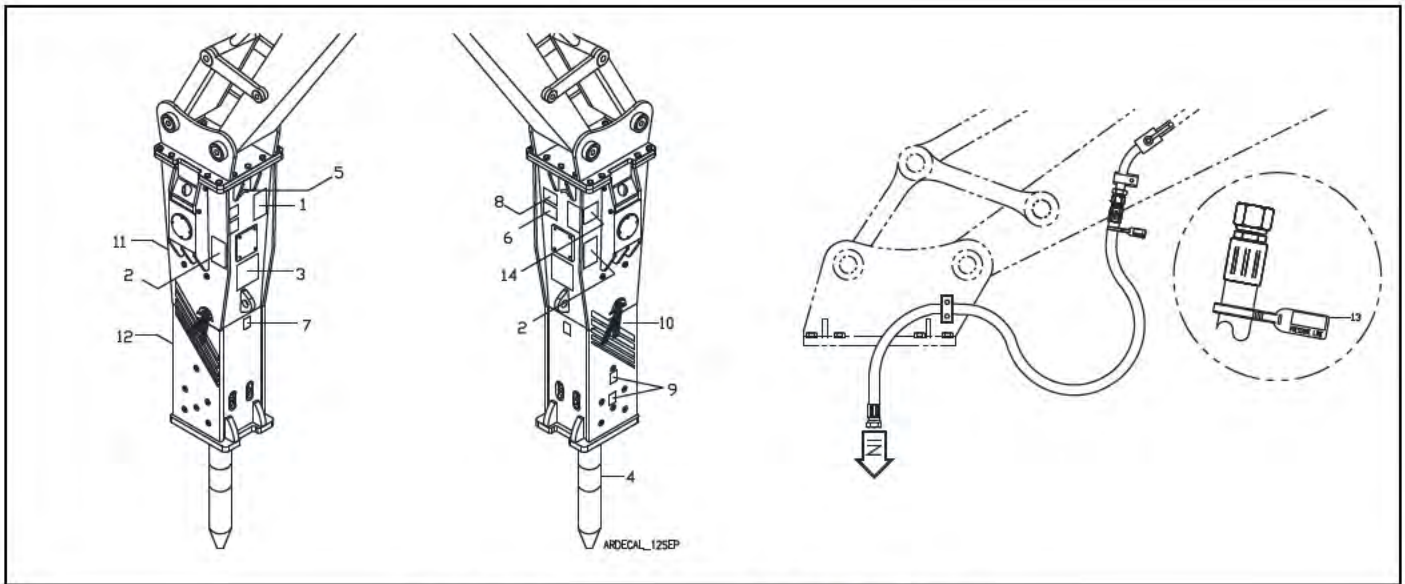
3.0 Safety and Information Labels [cont'd]**Fig. 3-15 Label Placement On the Equipment****Table 3.2 Label Set**

Item	Description	Part No.	Qty	Remarks / Specifications
---	Label Set – AR130	101634	1-Set	Set includes 1-13
---	Label Set – AR130B	571018	1-Set	Set includes 1-13
1	Read Manual / Instructions	676984	1	
2	Stay Clear	657841	2	
3.1	Thrown Debris – Projectile	657839	1	(Small) Display in conspicuous location inside operator's cab
3.2	Thrown Debris – Projectile	657839	1	(Large)
4	Tool Sharpening	657838	1	
5	Pressurized Accumulator	102756	1	
6	Maximum Operating Pressure	A103003	1	
7	Lift Point	676982	1	
8	Tool Lubrication	677334	1	
9	Tool Lubrication Point	A101725	2	
10	Allied "A" with Stripes	576283	2	
11	Allied Logo	576288	1	
12.1	Model AR130	101669	1	
12.2	Model AR130B	571019	1	
13	Pressure ID Tag	818676	1	Attach to supply line - IN
14	Equipment ID Tag	819026	1	Item 13 is not included in Set

4.0 Parts Information

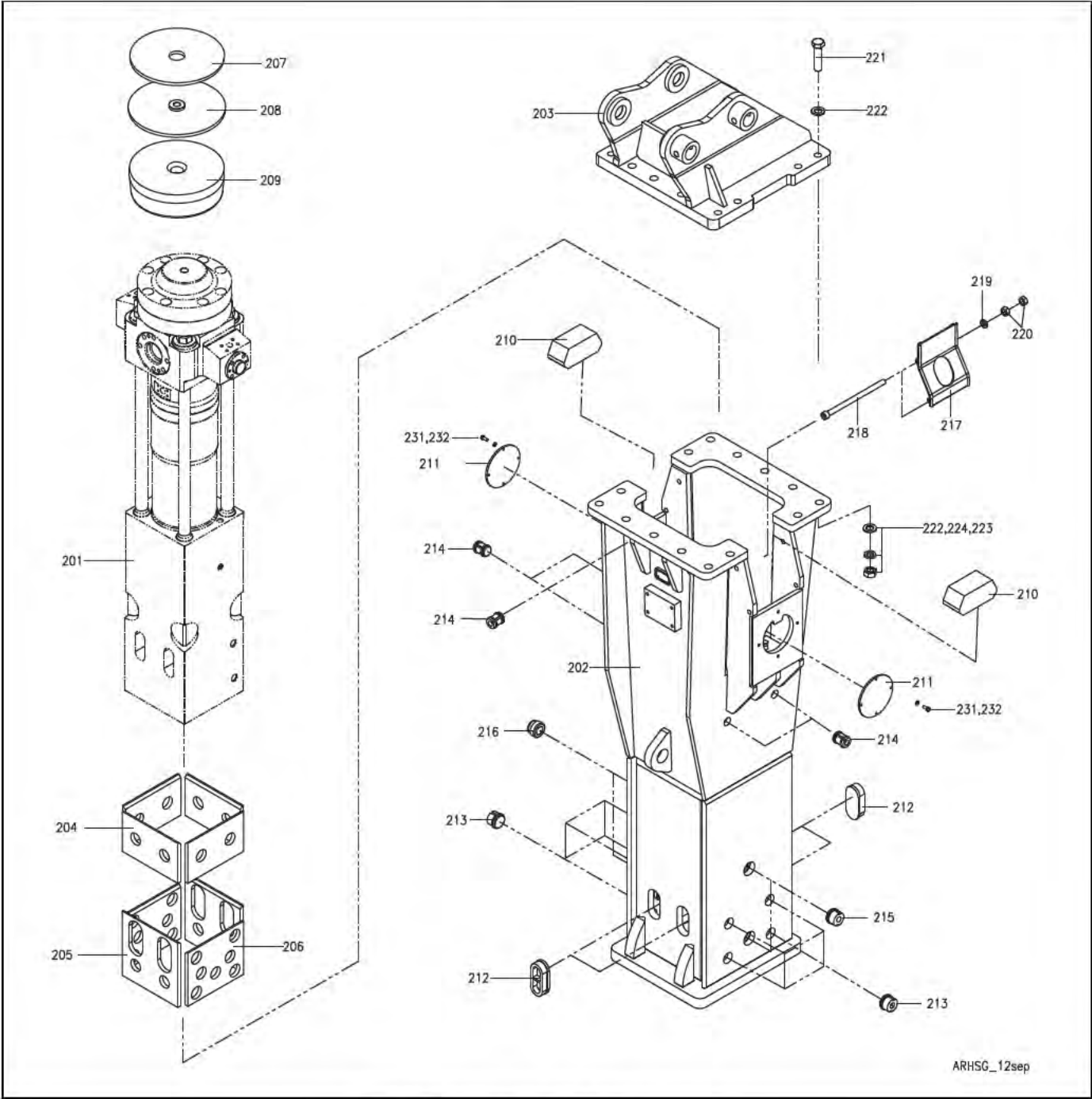

Fig. 4-1 Housing Box & Components

4.0 Parts Information [cont'd]**Table 4.1 Housing Box & Components**

Item	Part Name	Part N ^o .	QTY	⊕ AR130 ■ AR130B	Remarks / Specifications
200.1	AR130	101622	---	⊕	Breaker - Less Mounting Bracket 203
200.2	AR130B	571000	---	■	Breaker - Less Mounting Bracket 203
201.1	AR130 Breaker Ass'y	---	1	⊕	
201.2	AR130B Breaker Ass'y	---	1	■	
202	Housing Box	101032	1	⊕ ■	LR8 Mounting Flange
203	Mounting Bracket-LR8	Varies	---	⊕ ■	Not Included - Order Separately
204	Wear Plate	101515	4	⊕ ■	Upper
205	Wear Plate	101035	2	⊕ ■	Front-Lower
206	Wear Plate	101926	2	⊕ ■	Side-Lower
207	Wear Plate	101034	1	⊕ ■	Top
208	Damper	101516	1	⊕ ■	Top Plate
209	Buffer	101033	1	⊕ ■	Top
210	Buffer	101517	2	⊕ ■	Side
211.1	Cover - Rubber	570995	2	⊕	Early versions only
211.2	Cover - Steel Plate	573165	2	⊕ ■	
212	Plug	571001	4	⊕ ■	Rubber
213	Plug	572390	8	■	Rubber
214	Plug	570998	6	■	Rubber
215	Plug	575360	2	■	Rubber with access to grease nipple
216	Plug	B3200050	2	■	Rubber
217	Cover	570994	2	■	
218.1	Socket Head Bolt	571768	4	⊕ ■	M14 x 255
218.2	Socket Head Bolt	SB1420265	4	■	M14 x 265
219.1	Washer	678476	4	⊕	HC Split - Use discontinued
219.2	Washer	575257	4	⊕ ■	Flat
220.1	Cotter Pin	571008	4	⊕ ■	Used with 571768
220.2	Hex Nut	607264	8	⊕ ■	Qty 4 when used w/571768
221	Mounting Hardware	---	---	⊕ ■	221,222,223,224 Refer to Section 7
231	Hex Head Bolt	798062	8	■	
232	Washer	678458	8	■	

4.0 Parts Information [cont'd]

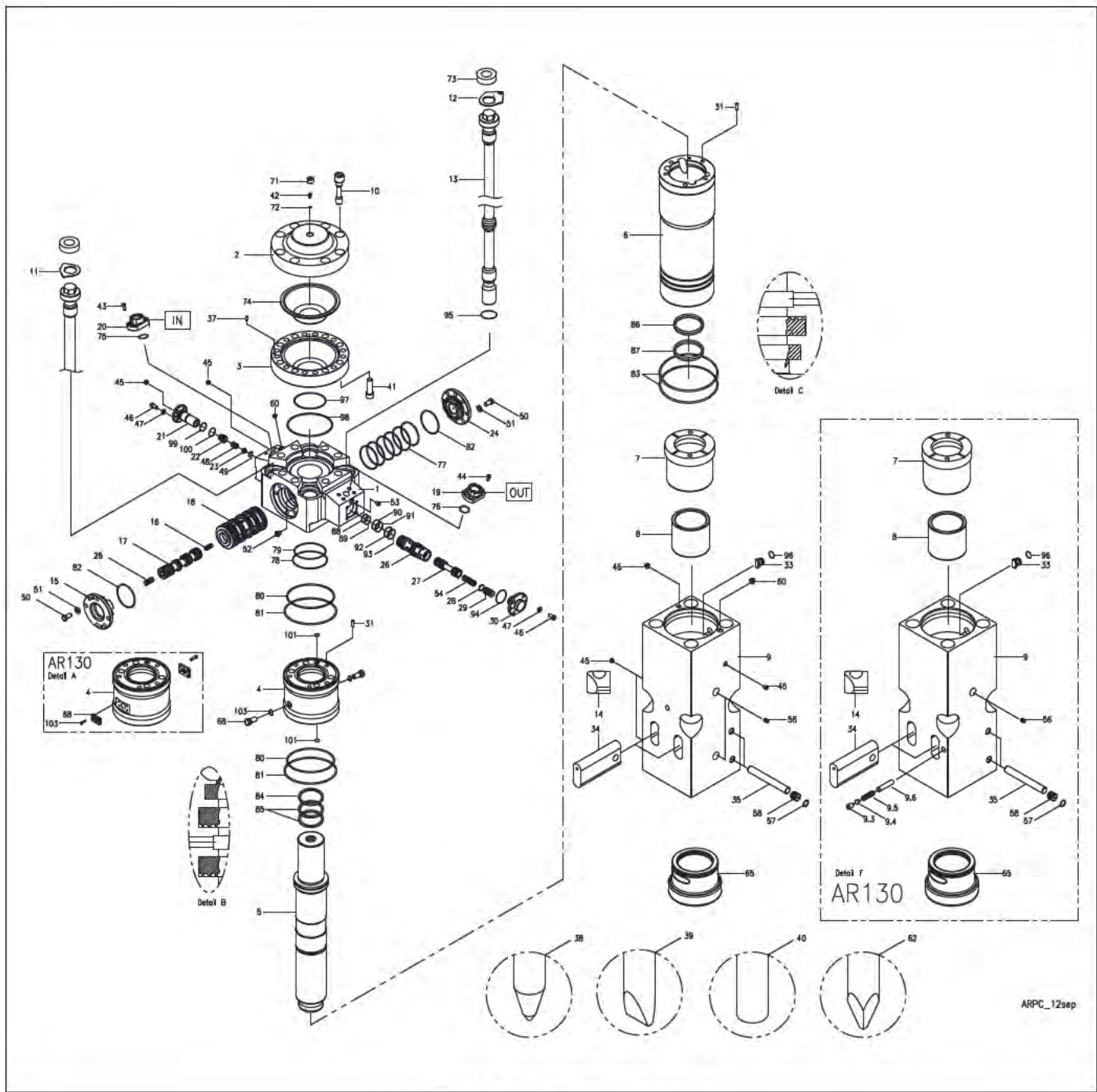

Fig. 4-2 Breaker Assembly

4.0 Parts Information [cont'd]**Table 4.2 Breaker Assembly**

Item	Description	Part N ^o .	QTY	⊕ AR130 ■ AR130B	Remarks / Specifications
1	Valve Housing	570983	1	⊕ ■	
2	Accumulator Cover	571893	1	⊕ ■	
3	Accumulator Bottom	101857	1	⊕ ■	
4.1	Seal Housing	101524	1	⊕	Detail A (Standard Type)
4.2	Seal Housing	571060	1	■	Newer design for use with vent plug - 68.2
5	Piston	A101955	1	⊕ ■	
6	Cylinder	570984	1	⊕ ■	
7.1	Thrust Ring	101897	1	⊕	Detail F
7.2	Thrust Ring	570986	1	■	
8	Tool Bushing	101899	1	⊕ ■	Upper
9.1	Front Head	A101954		⊕	Detail F
9.2	Front Head	570987		■	
9.3	Plug	102414	1	⊕	Rubber - Detail F
9.4	Spring Guide	676195	1	⊕	Detail F
9.5	Spring	A102631	1	⊕	Detail F
9.6	Pin	A101786	1	⊕	Detail F
10	Socket Head Bolt	102727	8	⊕ ■	
11	Lock Plate	101586	3	⊕ ■	
12	Lock Plate	570988	1	⊕ ■	
13	Side Rod	A101956	4	⊕ ■	
14	Lower Nut	101898	4	⊕ ■	Side Rod
15	Cover	102075	1	⊕ ■	Control Valve
16	Spool,	101863	1	⊕ ■	Rear
17	Spool	102012	1	⊕ ■	Main
18	Sleeve	102069	1	⊕ ■	
19.1	Flange Adapter-20	---	1	⊕ ■	[OUT] Use is discontinued (Tapered thread)
19.2	Flange Adapter	573221	1	⊕ ■	[OUT] 20 x 16 Straight thread
20.1	Flange Adapet-16	---	1	⊕ ■	[IN] Use is discontinued (Tapered thread)
20.2	Flange Adapter	572705	1	⊕ ■	[IN] 16 x 16 Straight thread
21	Housing	102108	1	⊕ ■	Check Valve
22	Spool	102109	1	⊕ ■	Check Valve
23	Guide	102204	1	⊕ ■	Check Valve
24	Cover	102101	1	⊕ ■	Control Valve

4.0 Parts Information [cont'd]

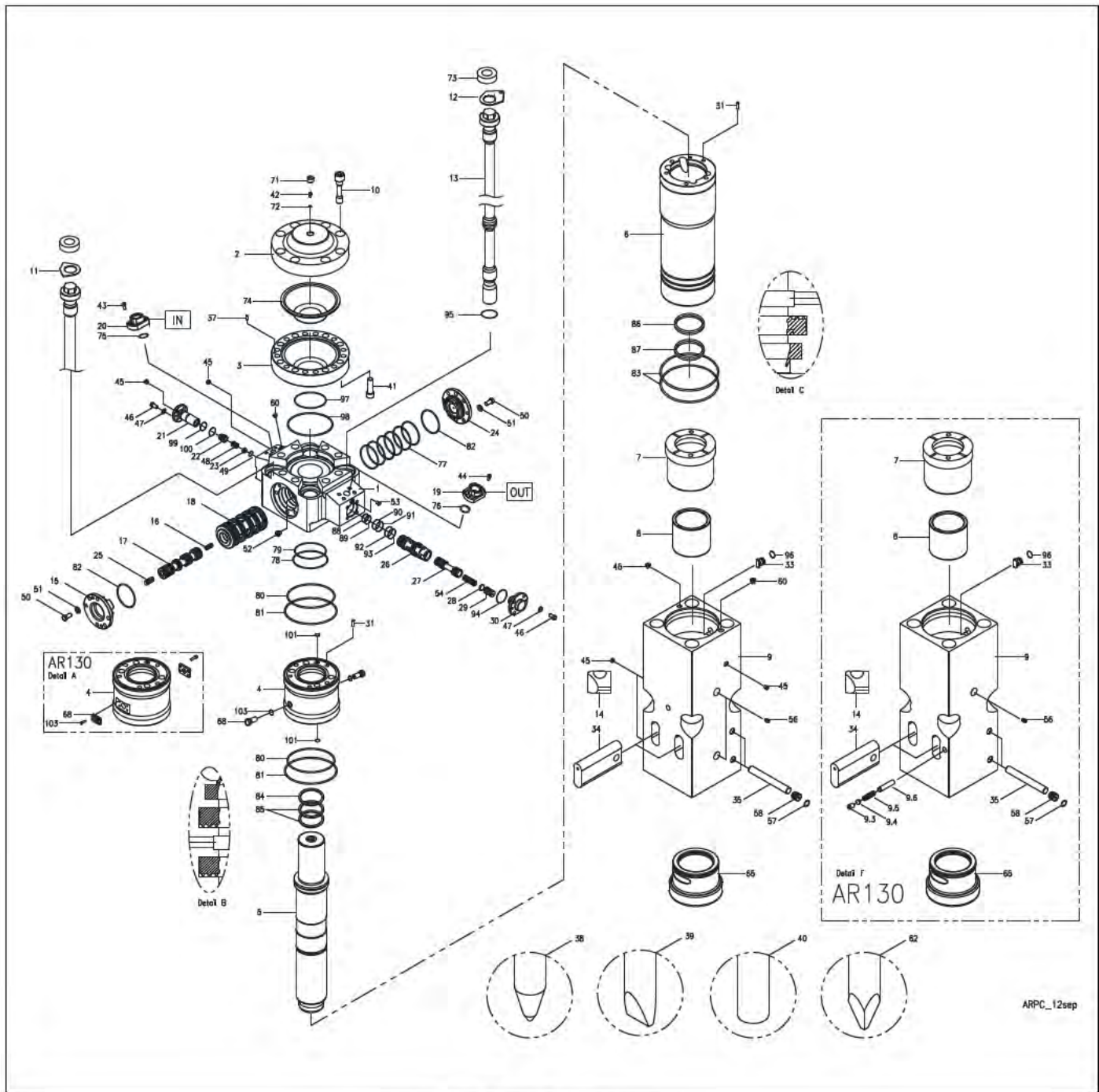

Fig. 4-2 Breaker Assembly

4.0 Parts Information [cont'd]**Table 4.2 Breaker Assembly [cont'd]**

Item	Description	Part N ^o .	QTY	⊕ AR130 ■ AR130B	Remarks / Specifications
25	Spool	101862	1	⊕ ■	Front
26	Regulator Guide	101844	1	⊕ ■	
27	Regulator Spool	101845	1	⊕ ■	
28	Spring Guide	A101846	1	⊕ ■	
29	Shim	101854	1	⊕ ■	
30	Cover	101855	1	⊕ ■	Regulator
31	Guide Pin	102545	2	⊕ ■	
33	Wedge	A102558	1	⊕ ■	
34	Tool Retainer Bar	A101580	2	⊕ ■	
35	Retainer Pin	A101787	2	⊕ ■	
37	Guide Pin	676183	1	⊕ ■	
38	Tool Selection	Varies	---	⊕ ■	Items 38,39,40,62 Refer to Section 5
41	Socket Head Bolt	102426	12	⊕ ■	
42	Gas Bolt	676161	1	⊕ ■	
43	Socket Head Bolt	103001	4	⊕ ■	M12 x 40
44	Socket Head Bolt	103002	4	⊕ ■	M14 x 40
45	Hex Socket Plug	676159	5	⊕ ■	
46	Hex Head Bolt	900023	8	⊕ ■	Regulator Cover
47	Disc Spring	571054	8	⊕ ■	
48	Check Valve Spring	102212	1	⊕ ■	
49	Lock Ring	102217	1	⊕ ■	
50.1	Sleeve Cover Bolt	101583	12	⊕	M16-30mm
50.2	Sleeve Cover Bolt	902766	12	■	M16-35mm
51	Lock Washer	571055	12	⊕ ■	
52	Hex Socket Plug	676216	1	⊕ ■	
53	Hex Socket Plug	102241	1	⊕ ■	
54	Regulator Spring	101856	1	⊕ ■	
56	Grease Nipple	816675	2	⊕ ■	Qty 1 req'd for S/N 00181 & below
57	Snap Ring	570072	2	⊕ ■	Qty 1 req'd for AR130
58	Rubber Plug	102412	2	⊕ ■	Qty 1 req'd for AR130

4.0 Parts Information [cont'd]

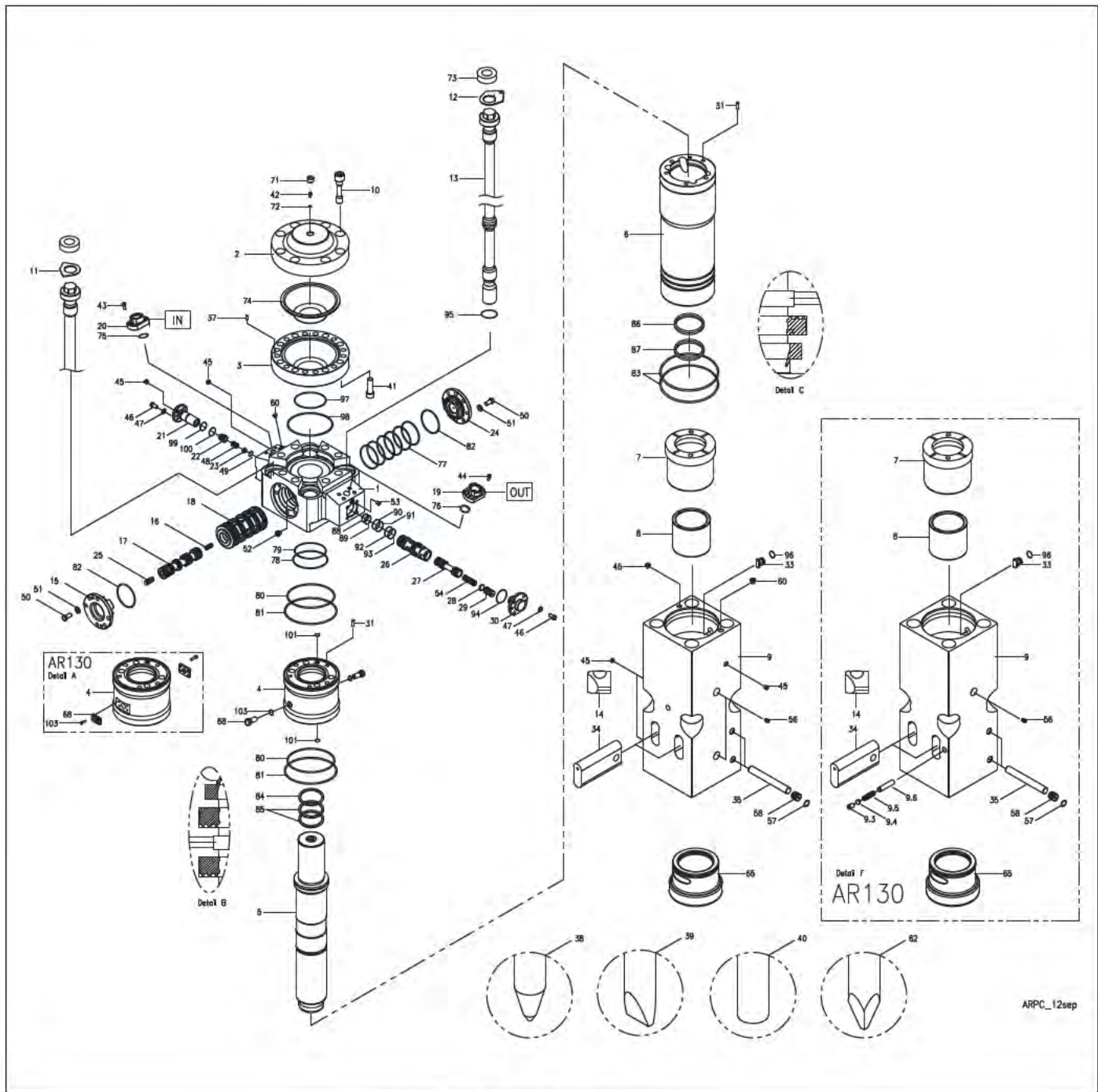

Fig. 4-2 Breaker Assembly

4.0 Parts Information [cont'd]**Table 4.2 Breaker Assembly [cont'd]**

Item	Description	Part N ^o .	QTY	⊕ AR130 ■ AR130B	Remarks / Specifications
60	Hex Socket Plug	573577	1	■	Plastic (POM)
60	Flange Plug	102241	1	■	
65	Tool Bushing	101523	1	⊕ ■	Lower
68.1	Cover, Breather Vent	102549	2	⊕ ■	Detail A
68.2	Air Vent Plug	B2006870	2	■	
71	Accumulator Cap	102262	1	⊕ ■	
72	Usit-Ring	676201	1	⊕ ■	
73	Rubber Ring	101585	4	⊕ ■	
74	Membrane	101784	1	⊕ ■	
75	O-Ring	677977	1	⊕ ■	
76	O-Ring	659275	1	⊕ ■	
77	O-Ring	A102329	6	⊕ ■	
78	O-Ring	A101774	1	⊕ ■	
79	Back-up Ring	101776	1	⊕ ■	
80	O-Ring	101777	2	⊕ ■	
81	Back-up Ring	101778	2	⊕ ■	
82	O-Ring	676202	2	⊕ ■	
83	O-Ring	101779	2	⊕ ■	Qty 1 req'd for AR130
84	Wiper	102314	1	⊕ ■	Detail B
85	Seal	102340	2	⊕ ■	Detail B
86	Seal w/ Anti-Extrusion Ring	102410	1	⊕ ■	Detail C
87	Wiper	101525	1	⊕ ■	Detail C
88	Back-up Ring	101790	1	⊕ ■	Detail E
89	O-Ring	101781	1	⊕ ■	Detail E
90	O-Ring	676251	1	⊕ ■	Detail E
91	Back-up Ring	101789	1	⊕ ■	Detail E
92	O-Ring	100109	1	⊕ ■	Detail E
93	Back-up Ring	101788	1	⊕ ■	Detail E
94	O-Ring	676203	1	⊕ ■	
95	O-Ring	101783	4	⊕ ■	Was Qty 2 for each side rod
96	O-Ring	676200	1	⊕ ■	
97	O-Ring	101839	1	⊕ ■	

4.0 Parts Information [cont'd]

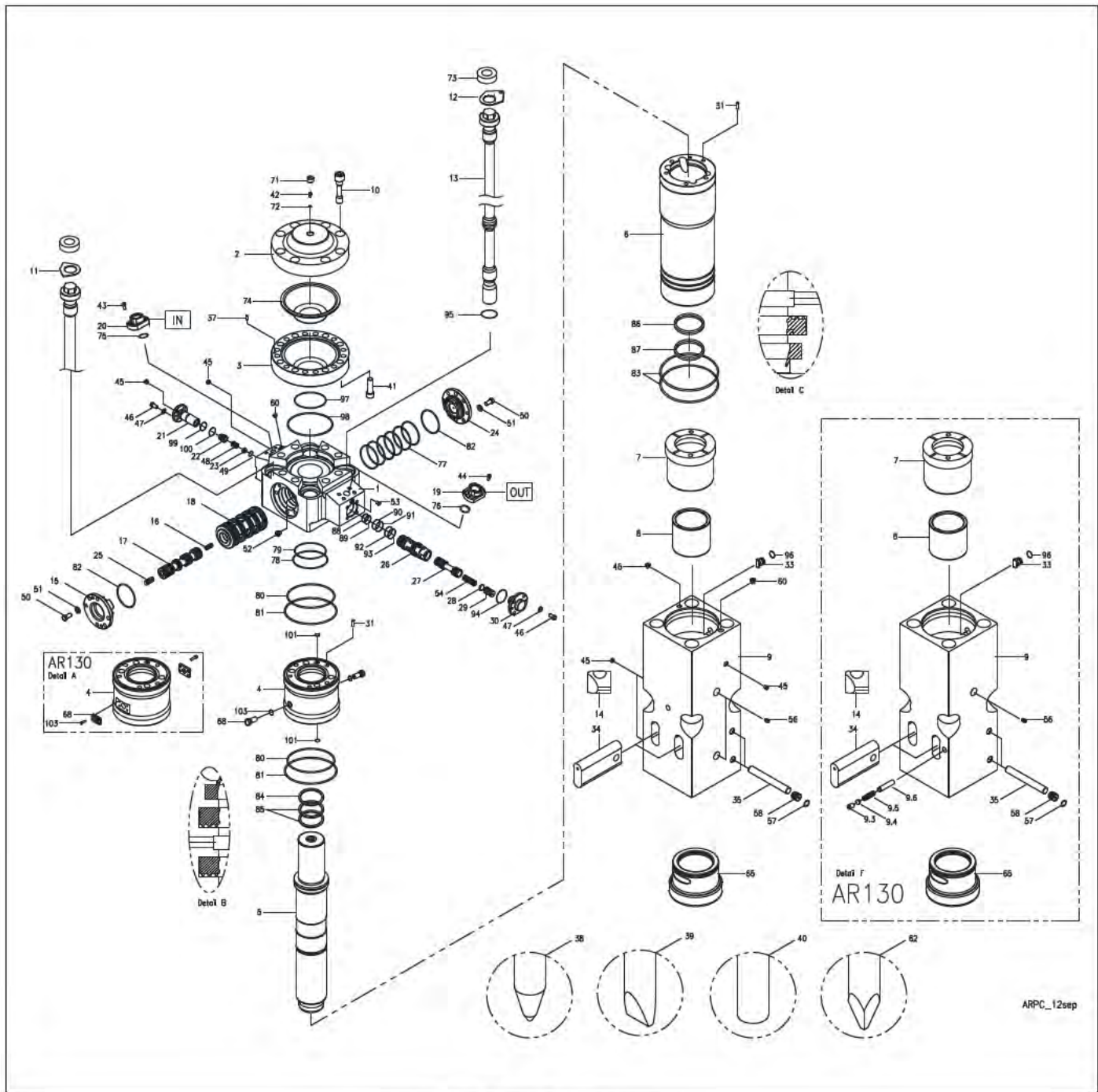

Fig. 4-2 Breaker Assembly

4.0 Parts Information [cont'd]

Table 4.2 Breaker Assembly [cont'd]

Item	Description	Part N ^o .	QTY	⊕ AR130 ■ AR130B	Remarks / Specifications
98	Back-up Ring	101840	1	⊕ ■	
99	O-Ring	676206	1	⊕ ■	
100	O-Ring	102333	1	⊕ ■	
101	O-Ring	571004	2	■	
103.1	Socket Head Bolt	940587	2	⊕ ■	Detail A
103.2	O-Ring	676209	2	■	
106	O-Ring	572386	1	⊕ ■	Use on Item 65 is discontinued
*	Guide Ring	102346	0	⊕ ■	Use is discontinued - Detail D

4.0 Parts Information [cont'd]

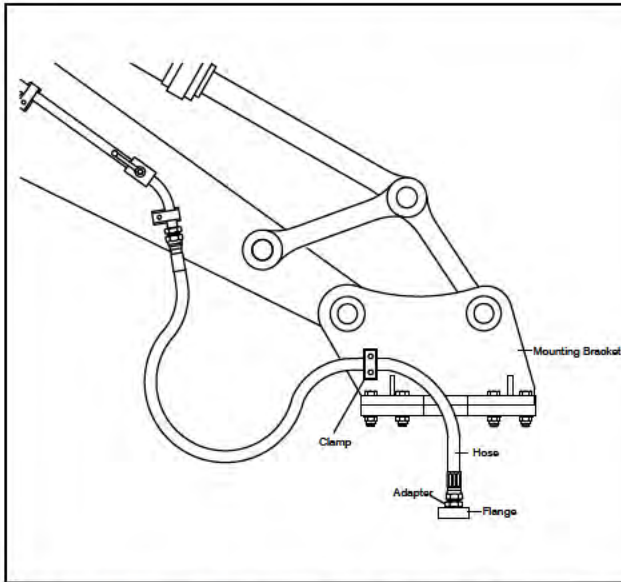

Fig. 4-3 Hose Routing To Excavator - Typical

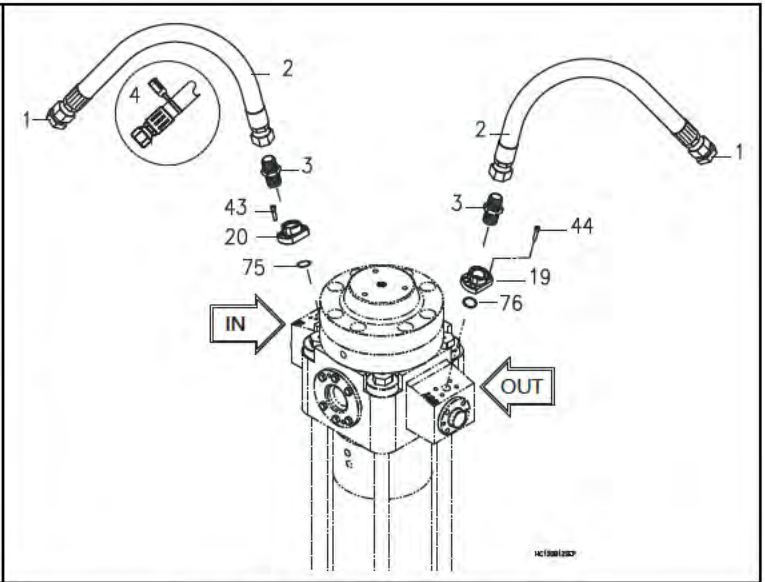

Fig. 4-4 Hydraulic Connections

Table 4.3 Hydraulic Connections

Item	Description	Part No.	Qty	⊕ AR130 ■ AR130B	Remarks / Specifications
1	Plug	814454	2	⊕ ■	
2	Hose	676124	2	⊕ ■	
3	Adapter	656745	2	⊕ ■	
4	Pressure "IN" ID Tag	818676	1	⊕ ■	Identifies the oil supply line "IN"
19.1	Flange Adapter	---	1	⊕ ■	[OUT] Use is discontinued (Tapered thread)
19.2	Flange Adapter	573221	1	⊕ ■	[OUT] 20 x 16 Straight thread
20.1	Flange Adapter	---	1	⊕ ■	[IN] Use is discontinued (Tapered thread)
20.2	Flange Adapter	572705	1	⊕ ■	[IN] 16 x 16 Straight thread
43	Socket Head Bolt	90564	4	⊕ ■	M12 x 40
44	Socket Head Bolt	103002	4	⊕ ■	M14 x 40
75	O-Ring	677977	1	⊕ ■	
76	O-Ring	659275	1	⊕ ■	
---	Hose Clamp	054010	2	⊕ ■	Fig 4-3 Part of Mounting Bracket

5.0 Tool Selection

5.1 Standard Tools

The three most commonly used tool points for concrete and rock demolition are the Chisel, Conical and Blunt.

A. Chisel (Wedge – Cross Cut or In-Line) – Suitable applications include soft rock and general demolition of concrete. The tool penetrates into the material, forcing it to separate. Useful when cutting action is required, e.g. benching and trenching.

B. Conical Point – Same applications as the chisel. The conical tool also penetrates, but unlike the chisel, the rounded shape resists twisting that can cause burring in the tool's retainer pin area.

C. Blunt – Designed for impact breaking. The blunt tool is effective in secondary breaking of oversize rock or boulder reduction.

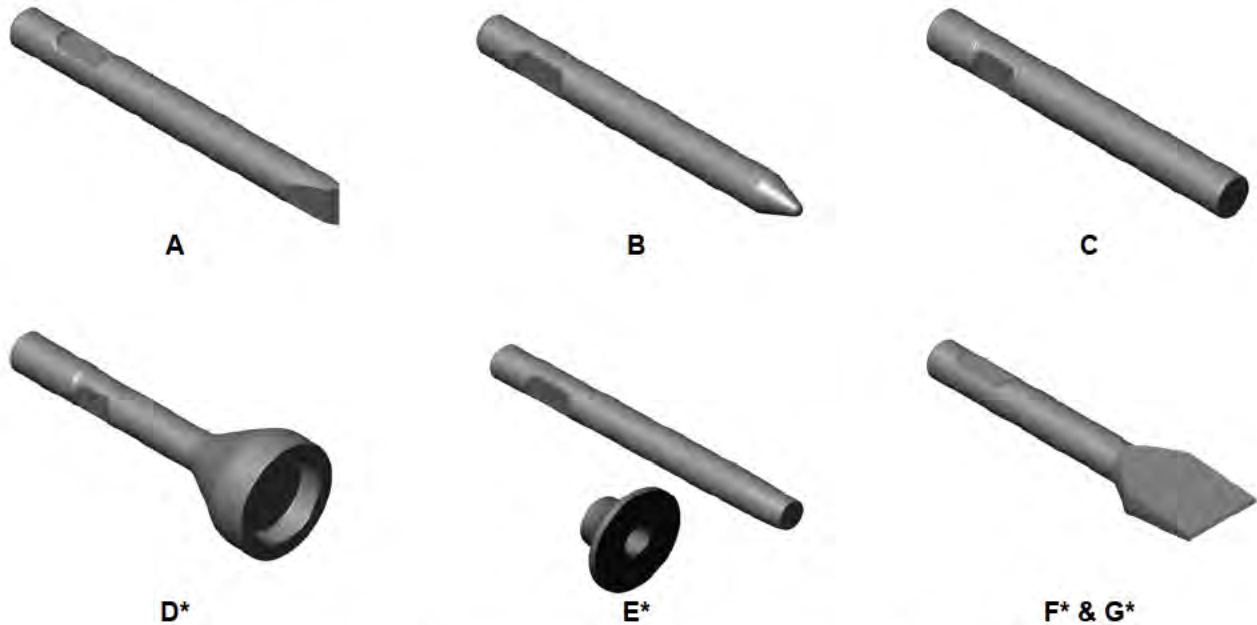

Fig. 5-1 Tool Selection - Standard and Specialty*
(*Shown are general illustrations. Actual tool design may vary)

5.2 Specialty Tools*

Specialty tools have a specific purpose or function designed into each tool. These tools can extend the versatility of a breaker, thus increasing productivity and eliminating the need for additional equipment. For availability of tool types not listed, contact Allied.
*Not available for all models.

D. Post Driver – For driving posts, pipes, etc.

E. Tamper – Designed to compact loose material.

F. Frost Cutter – For cutting into frozen ground.

G. Asphalt Cutter – Designed to cut seams in asphalt for removal. Useful when removing asphalt to dig a trench. Available in Cross-Cut and In-Line configurations.

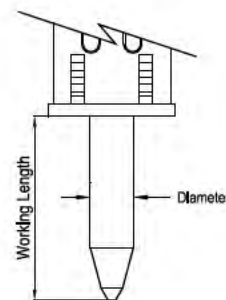

Fig. 5-2 TD & WL

5.0 Tool Selection – [cont'd]

Table 5.1 Tool Selection

Item	Description	Part No.	WL [mm] x TD in. [mm]	Weight lbs. [kg.]
38-B	Conical Point	101587	27 in. (685mm) x 5.12 in [130mm]	220 lbs. (100 kg.)
39-A¹	Chisel Cross Cut	100859	27 in. (685mm) x 5.12 in [130mm]	220 lbs. (100 kg.)
---	Chisel In-Line	---	---	---
40-C	Blunt End	102950	23 in. (585mm) x 5.12 in [130mm]	200 lbs. (90 kg.)
62 ²	Pyramid (Not Pictured)	---	---	---

¹⁾ **Standard tool supplied with Breaker in Bold**

²⁾ For availability of tool types not listed, contact Allied

5.3 Bushing and Tool Lubrication

When choosing a grease to lubricate the bushing and tool, it's important to emphasize that the "right type" is equally important as "how much" and "how often".

Every day wear-and-tear is unavoidable and no other component receives more punishment than the bushing and tool. Each time the breaker is put to work, the tool and bushing are subjected to extreme pressure, heat and abrasive debris. These parts are made of high quality, heat-treated alloy steel, yet, inattention to re-lubrication schedules or using a lubricant that's insufficiently formulated for this application will cause rapid wear and render parts unusable. Replacing these parts can be costly, both in terms of down time and price.

When applied regularly, Allied Chisel Paste provides the contact surfaces between the bushing and tool with superior protection against friction related damage. It's formulated of a unique blend of high-viscosity petroleum oil and solid lubricants. Solids are essential additives in applications that involve sliding with heavy side loading. Solids provide a high-strength boundary between the bushing and tool that effectively reduce metal-to-metal contact and thereby reduce heat-generated damage from friction.

Allied Chisel Paste is specifically formulated for the lubrication of the bushing and tool. In comparison, greases labeled "General Purpose" or "Multi-Purpose" are less expensive because they typically contain fewer additives and are unlikely to possess any solid content. When General or Multi-purpose grease is subjected to heavy side loading, the oil is squeezed out, leaving the bushing and tool unprotected against friction related damage.

Grease that fails to stay put under conditions of heavy vibration and high temperatures loses its effectiveness to lubricant. The better the ability of the

grease to stay put on critical surfaces, the better the protection against friction. Allied chisel paste out performs General or Multi-purpose grease that lack sufficient additives critical for clinging. Special thickening agents in chisel paste help ensure that the lubricant adheres to metal surfaces as temperatures get hot.

Many factors, including operator technique, determine whether the breaker will remain productive. But with attention to preventive maintenance practices, including timely lubrication, and through the regular use of Allied Chisel Paste, the usable service life of these parts can be maximized while the cost to replace them and loss of production from down time is minimized.

Allied Chisel Paste Specifications

- NLGI Grade - No. 2
- Thickener Type – Calcium sulfonate complex
- Solids include graphite and copper
- Dropping Point ° F (° C), min. – 500 (260)
- Oil Viscosity @ 100° F (40° C) – 200-240

Application methods include brushing, grease gun and all Allied automatic grease dispensers

Table 5-2 Chisel Paste Ordering Information

Container	Packaging	Part No.
14.5 oz. Tubes*	Qty x 10	574430
14.5 oz. Tubes*	Qty x 30	574431
35 lb. Bucket	Qty x 1	676698
120 lb. Drum	Qty x 1	679968

*Fits standard hand operated grease guns.

6.0 Service Kits and Tools

6.1 Tune-up Kit

Restore performance and maintain the reliability of the breaker by replacing common wear items.

Contents of the Tune-up kit includes a full set of seals, lower tool bushing, tool retainer and accumulator membrane.

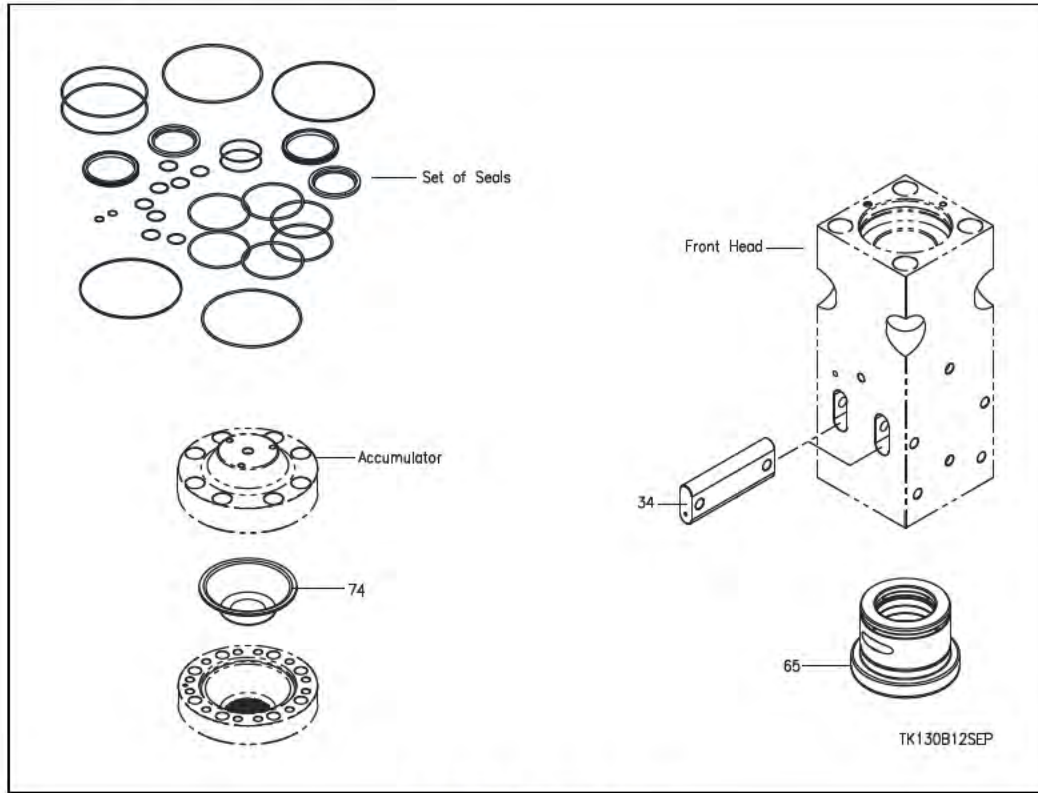

Fig. 6-1 Tune-up Kit

Table 6.1 Tune-up Kit

Item	Description	Part N ^o .	QTY	⊕ AR130 ■ AR130B	Remarks / Specifications
---	Tune-up Kit	102862	1-Kit	⊕ ■	Kit includes all items in Table 6.1
---	Seal Set	102836	1-Set	⊕ ■	Refer to Table 6.2
34	Tool Retainer Bar	A101580	2	⊕ ■	
65	Lower Bushing	101523	1	⊕ ■	
74	Membrane	101784	1	⊕ ■	

6.0 Service Kits and Tools [cont'd]

6.2 Seal Set

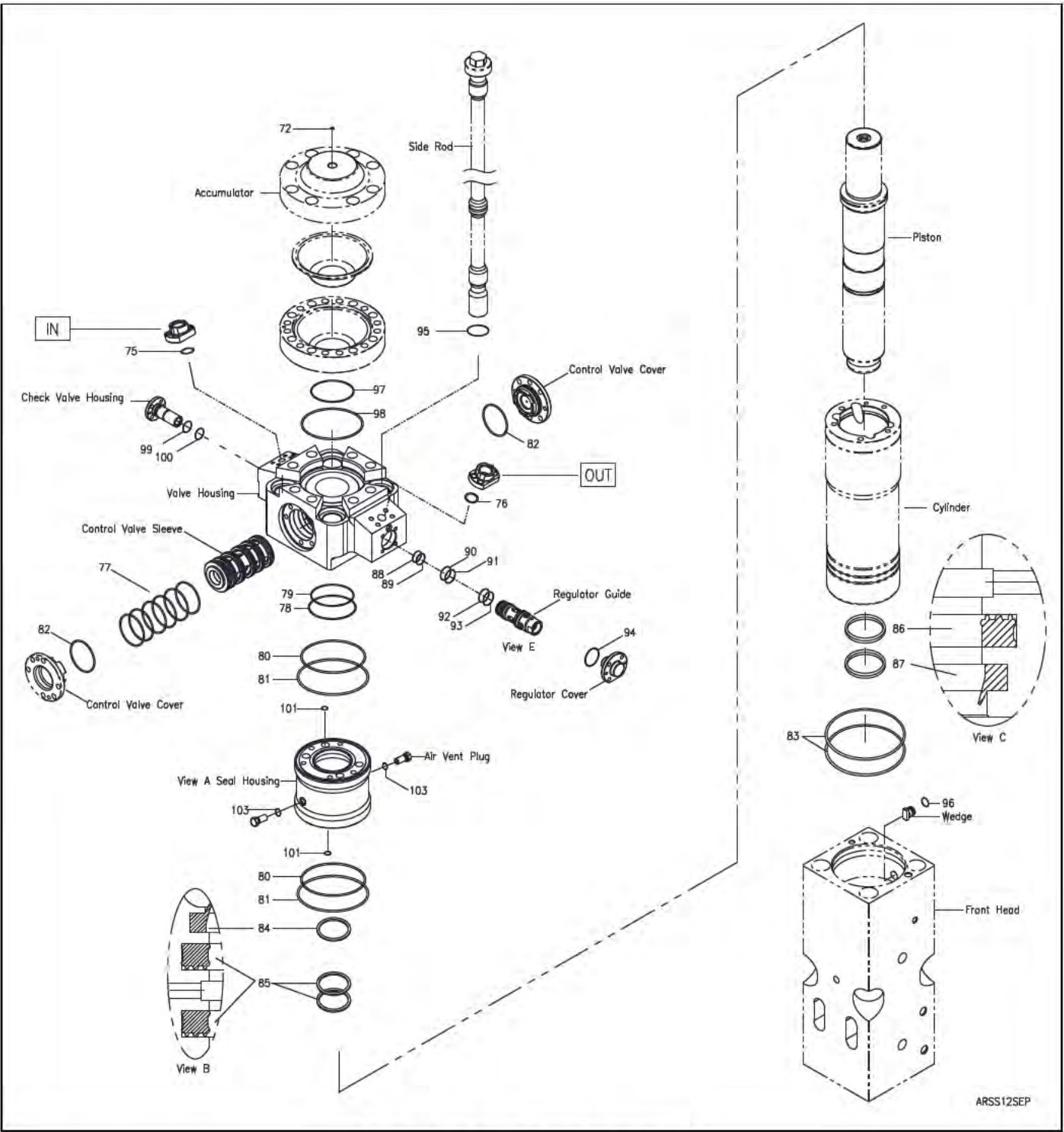

Fig. 6-2 Seal Set – Position of Seals



See Repair Manual for Assembly Details

6.0 Service Kits and Tools [cont'd]**Table 6.2**

Pos.	Description	Part N ^o .	QTY	⊕ AR130 ■ AR130B	Remarks / Specifications
---	Seal Set	102836	1	⊕ ■	Fig. 6-2
72	Usit-ring	676201	1	⊕ ■	
75	O-Ring	677977	1	⊕ ■	
76	O-Ring	659275	1	⊕ ■	
77	O-Ring	A102329	6	⊕ ■	
78	O-Ring	A101774	1	⊕ ■	
79	Back-up Ring	101776	1	⊕ ■	
80	O-Ring	101777	2	⊕ ■	
81	Back-up Ring	101778	2	⊕ ■	
82	O-Ring	676202	2	⊕ ■	
83	O-Ring	101779	2	⊕ ■	Qty 1 req'd for AR130
84	Wiper	102314	1	⊕ ■	Detail B
85	Seal	102340	2	⊕ ■	Detail B
86	Seal w/Anti-extrusion ring	102410	1	⊕ ■	Detail C
87	Wiper	101525	1	⊕ ■	Detail C
88	Back-up Ring	101790	1	⊕ ■	Detail E
89	O-Ring	101781	1	⊕ ■	Detail E
90	O-Ring	676251	1	⊕ ■	Detail E
91	Back-up Ring	101789	1	⊕ ■	Detail E
92	O-Ring	100109	1	⊕ ■	Detail E
93	Back-up Ring	101788	1	⊕ ■	Detail E
94	O-Ring	676203	1	⊕ ■	
95	O-Ring	101783	4	⊕ ■	Was Qty 2 for each side rod
96	O-Ring	676200	1	⊕ ■	
97	O-Ring	101839	1	⊕ ■	
98	Back-up Ring	101840	1	⊕ ■	
99	O-Ring	676206	1	⊕ ■	
100	O-Ring	102333	1	⊕ ■	
101	O-Ring	571004	2	■	
103	O-Ring	676209	2	■	Detail A
106	O-Ring	572386	1	⊕ ■	Use on Item 65 is discontinued
*	Guide Ring	---	0	⊕ ■	Detail D Use of (*) is discontinued
---	Thread Lube	676927	1	⊕ ■	Use on side rod threads. Follow application instructions.

6.0 Service Kits and Tools [cont'd]

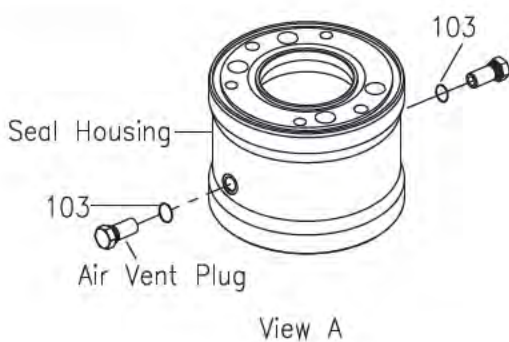

Fig 6-3 Position of Seals

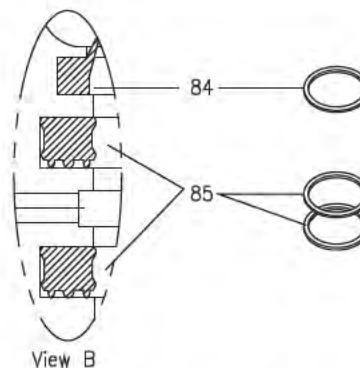

Fig 6-4 Position of Seals

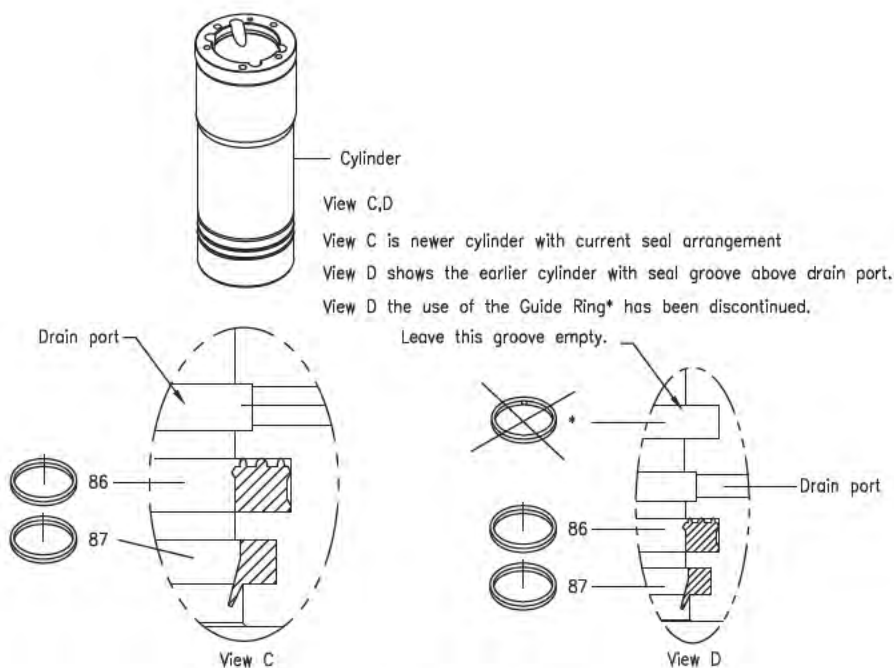

Fig 6-5 Position of Seals

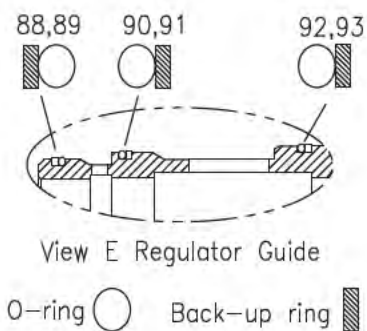

Fig 6-6 Position of Seals

IMPORTANT

Contamination interferes with reliable operation and will shorten component life. Prevent dirt and debris from entering the hydraulic system. Always work in a clean area. Keep seals properly stored in their original, sealed package until ready for use.

6.0 Service Kits and Tools [cont'd]

6.3 N2 Gas Charge Tool

The accumulator is a self-contained pressure vessel with a flexible membrane dividing the inner chamber. The lower chamber is used to receive, store and discharge pressurized oil. Nitrogen gas under pressure is stored in the upper chamber.

Filling with nitrogen (N2) gas is accomplished with the charging unit (Fig. 7-1) and a commercially available nitrogen bottle. Table 7.1 lists items included in the charge kit.

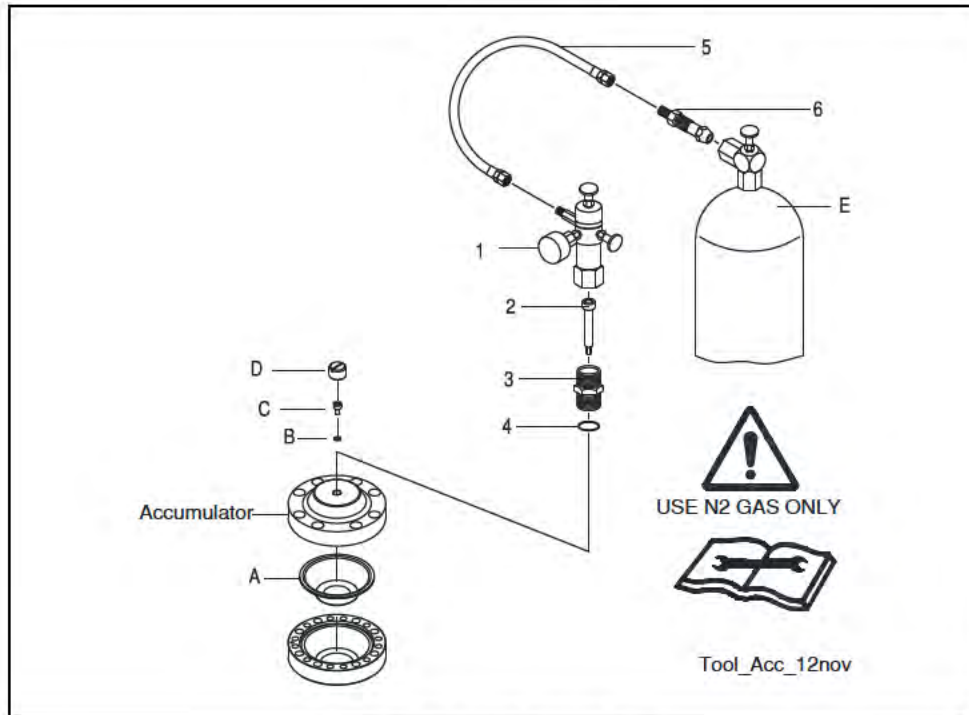

Fig. 6-7 N2 Gas Charge Tool

Table 6.3 N2 Gas Charge Kit

Item	Part No.	Description	Qty	Specifications
---	570071	N2 Gas Charge Tool	1-Kit	Kit includes 1,2,3,4,5,6
1	100527	Charge Valve with Gauge	1	Includes 2-6 (& storage case – not shown)
2	40601	Socket Bolt	1	
3	R101635	Adaptor	1	
4	901135	O-ring	1	
5	N/A	Hose	1	8 Ft. [2.5 M] Not Sold Separately
6	N/A	Gas Bottle Adapter	1	Not Sold Separately
E	N/A	Nitrogen Gas Bottle	---	Not Supplied (Source Locally)
A,B,C,D,E	---	Accumulator, Membrane, U-sit ring, Bolt, Cap, N2 Bottle	---	Items A,B,C,D,E not included in charge kit. They are shown for reference only.



Read, understand and follow all instructions given in Repair Manual 572591 for the safe and proper use of this tool.

7.0 Mounting Brackets and Hardware

7.1 Mounting Brackets

A mounting bracket (sold separately) is required to attach the Breaker to a carrier. Allied offers an array of mounting brackets to fit virtually any carrier, including those equipped with quick mounting couplers.

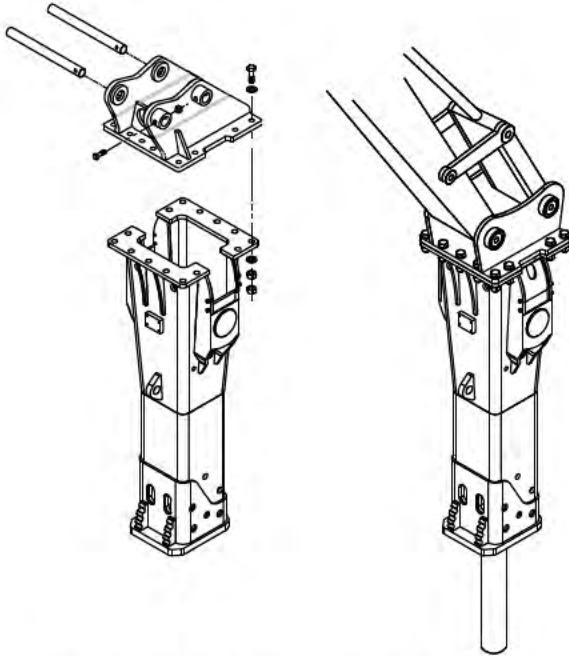

Fig. 7-1 Housing Box, Mounting Bracket & Hardware (Typical)

7.2 Connection Plate

The mounting bracket is bolted to the connection plate located at the upper end of the housing box. Dimensions of the connection plate, including thickness, spacing, quantity and diameter of the bolt holes, will vary between small, medium and large size breakers. Dimensions for the connection plate can be found in Operation & Maintenance Manual.

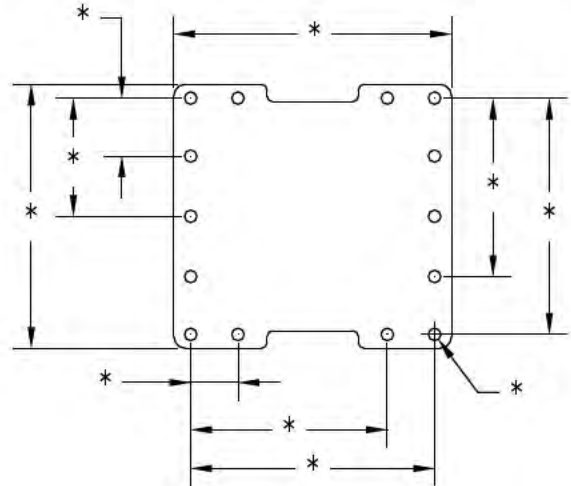

Fig. 7-2 Connection Plate Dimensions

In Table 7.1, "Family" identifies the connection plate used on each of the AR-Series models.

Other work tools from Allied, including the Ho-Pac® (vibratory plate compactor) will use these same mounting families.

Table 7.1 Mounting Family & Hardware

Model	Family	Bolt	FL Washer	LK Washer	Nut
AR70C, A75B	BR	90566 (12)	921825 (24)	100088 (12)	90548 (12)
AR85B, AR95B	SR	572352 (10)	679422 (20)	571027 (10)	572353 (10)
AR110B, AR110C, AR120B	MR	101765 (14)	901291 (28)	658529 (14)	90507 (14)
AR130B, AR140B	LR8	101765 (14)	901291 (28)	658529 (14)	90507 (14)
AR160C, AR165, AR170C, AR175	LR9	573167 (14)	573029 (28)	573028 (14)	90519 (14)
AR180C	LR10	573030 (14)	573029 (28)	573028 (14)	90519 (14)



See Operation & Maintenance Manual for Tightening Torque

8.0 How To Order Spare Parts

Your local Allied dealer requires the Product Name, Model and Serial Number to better assist you with questions regarding parts, warranty, operation, maintenance, or repair. This information should be noted in Section 2.3 of this manual.

Product _____

Model _____

Serial No. _____

Please fill out completely

Line	Part Number	Description	Quantity	Price
1				
2				
3				
4				
5				
6				
7				
8				
9				
10				

Your contact information

Your Name _____ Company Name _____

Phone _____ Account Number _____

Fax _____ Purchase order _____

Email _____ Shipping carrier _____

*See note below

Billing Address _____ Shipping Address _____

*Note: All backordered parts will be shipped when available via the same method as the original order unless initialed and checked below:

Initials

_____ ☐ Ship complete order only

_____ ☐ Ship available parts and contact customer on disposition of backordered parts

_____ ☐ Other – specify below

NOTES

[illegible]

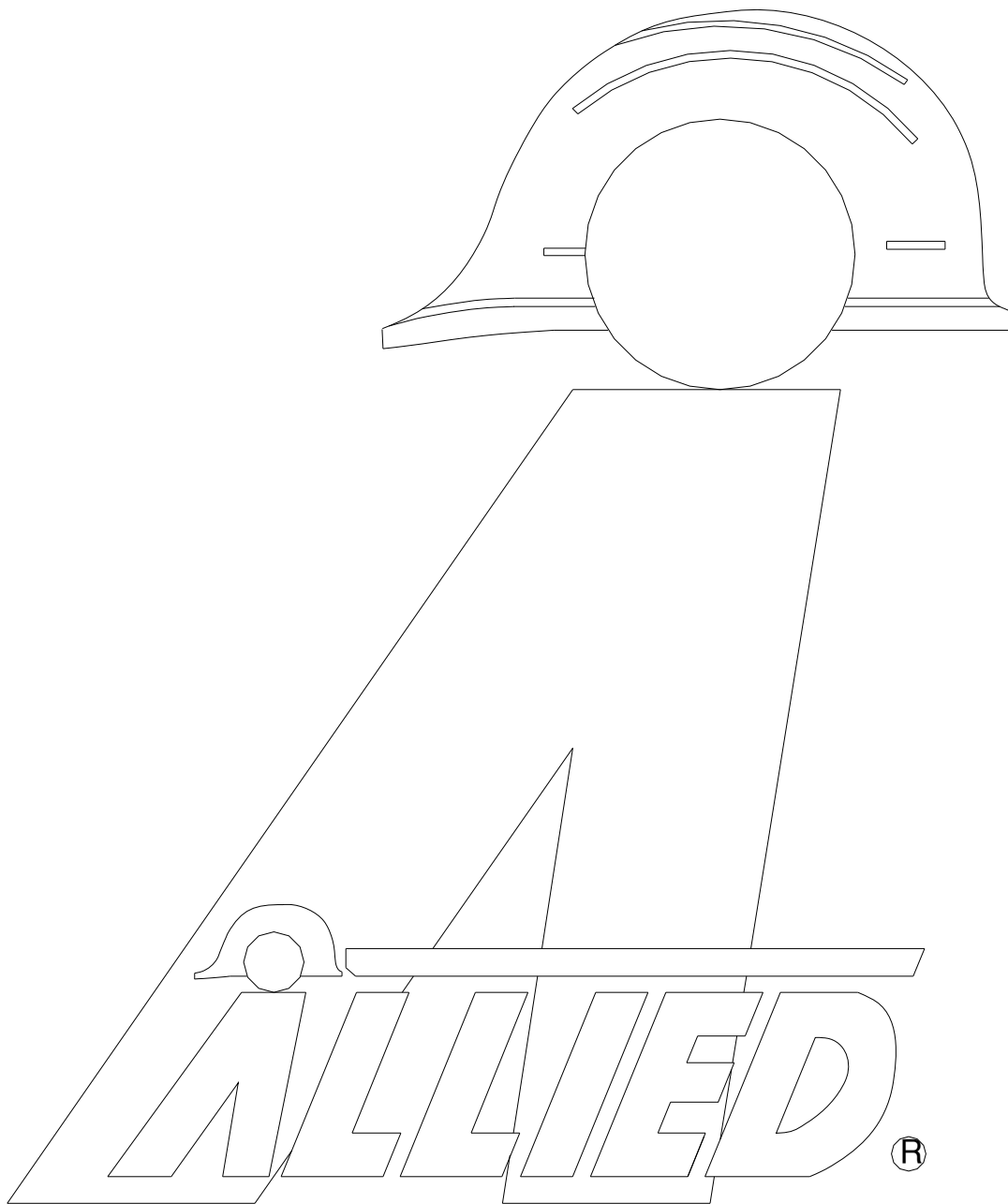

3900 Kelley Avenue, Cleveland, Ohio 44114
Tel: 216-431-2600 Fax: 216-431-2601
e-mail: Sales@AlliedCP.com
website: <http://www.AlliedCP.com>